

TA706120

FIGURE 38. HUB AND BRAKEDRUM ASSEMBLY (M127).

Current part is item (8,12) on diagram. Available at [www.oshkoshequipment.com](http://www.oshkoshequipment.com)

SECTION (1)	II (2)	TM9-2330-207-24P (3)	(4)	(5)	(6)
ITEM NO	SMR CODE	CAGEC	PART NUMBER	DESCRIPTION AND USABLE ON CODES (UOC)	QTY
GROUP 13 WHEELS AND TRACKS					
GROUP 1311 WHEEL ASSEMBLY					
FIG. 38 HUB AND BREAKDOWN ASSEMBLY (M127)					
1	PAOZZ	19207	7409553	RING, WIPER UOC: 260	2
2	PAOZZ	19207	7409389	BOLT, RIBBED SHOULDE UOC: 260	20
3	PAOZZ	19207	7409556	DEFLECTOR, DIRT AND UOC: 260	2
4	PAOZZ	19207	7521631	BOLT UOC: 260	20
5	PAOZZ	88044	AN935-816	WASHER, LOCK UOC: 260	40
6	XBOZZ	19207	7409388	ADAPTER UOC: 260	2
7	PAOFF	19207	7409394	BRAKE DRUM UOC: 260	2
8	PAOZZ	19207	7979315	COVER, ACCESS UOC: 260	2
9	PAOZZ	96906	MS35338-47	WASHER, LOCK UOC: 260	20
10	PAOZZ	96906	MS51968-11	NUT, PLAIN, HEXAGON UOC: 260	20
11	PAOZZ	19207	7979349	SEAL, PLAIN ENCASED UOC: 260	2
12	PAOZZ	19207	7409349	CONE AND ROLLERS, TA INNER UOC: 260	2
13	PAOZZ	19207	7409395	HUB CAPS WHEEL WITH BEARING CUP UOC: 260	2
14	PAOZZ	00447	428579	. CUP, TAPERED ROLLER INNER AND OUTER UOC: 260	2
15	PAOZZ	19207	7411072	CONE AND ROLLERS, TA OUTER UOC: 260	2
16	PAOZZ	19207	7979308	NUT, PLAIN, OCTAGON UOC: 260	2
17	PAOZZ	19207	5139123	WASHER, KEY UOC: 260	2
18	PAOZZ	19207	7346885	NUT, PLAIN, OCTAGON UOC: 260	2
19	PAOZZ	19207	7979275	GASKET UOC: 260	2
20	PAOZZ	78500	3262L90	COVER, ACCESS UOC: 260	2
21	PAOZZ	96906	MS90728-113	SCREW, CAP, HEXAGON, H UOC: 260	10
22	PAOZZ	96906	MS51983-4	NUT, PLAIN, SINGLE BA 1-1/8-16NF-2, (WHEEL STUD, RIGHT OUTER) RH THREADS UOC: 260	10

Current part is item (8,12) on diagram. Available at [www.oshkoshequipment.com](http://www.oshkoshequipment.com)

Current part is item (8,12) on diagram. Available at [www.oshkoshequipment.com](http://www.oshkoshequipment.com)

SECTION II (1)	ITEM (2)	SMR (3)	TM9-2330-207-24P (4)	(5)	(6)
NO	CODE	CAGEC	PART NUMBER	DESCRIPTION AND USABLE ON CODES (UOC)	QTY
22	PAOZZ	96906	MS51983-3	NUT,PLAIN,SINGLE BA LEFT OUTER UOC:260	10
23	PAOZZ	96906	MS53068-1	NUT,CAP,DUAL WHEEL INNER RIGHT UOC:260	10
23	PAOZZ	96906	MS53068-2	NUT,CAP,DUAL WHEEL LEFT, INNER UOC:260	10
24	PAOZZ	96906	MS51946-1	BOLT,RIBBED SHOULDE WHEEL, LH THD UOC:260	10
24	PAOZZ	96906	MS51946-2	BOLT,RIBBED SHOULDE R.H. THD UOC:260,673,674,680	10

END OF FIGURE



Current part is item (8,12) on diagram. Available at [www.oshkoshequipment.com](http://www.oshkoshequipment.com)

Current part is item (8,12) on diagram. Available at [www.oshkoshequipment.com](http://www.oshkoshequipment.com)



Current part is item (8,12) on diagram. Available at [www.oshkoshequipment.com](http://www.oshkoshequipment.com)

SECTION II

TM 9-2330-207-24P

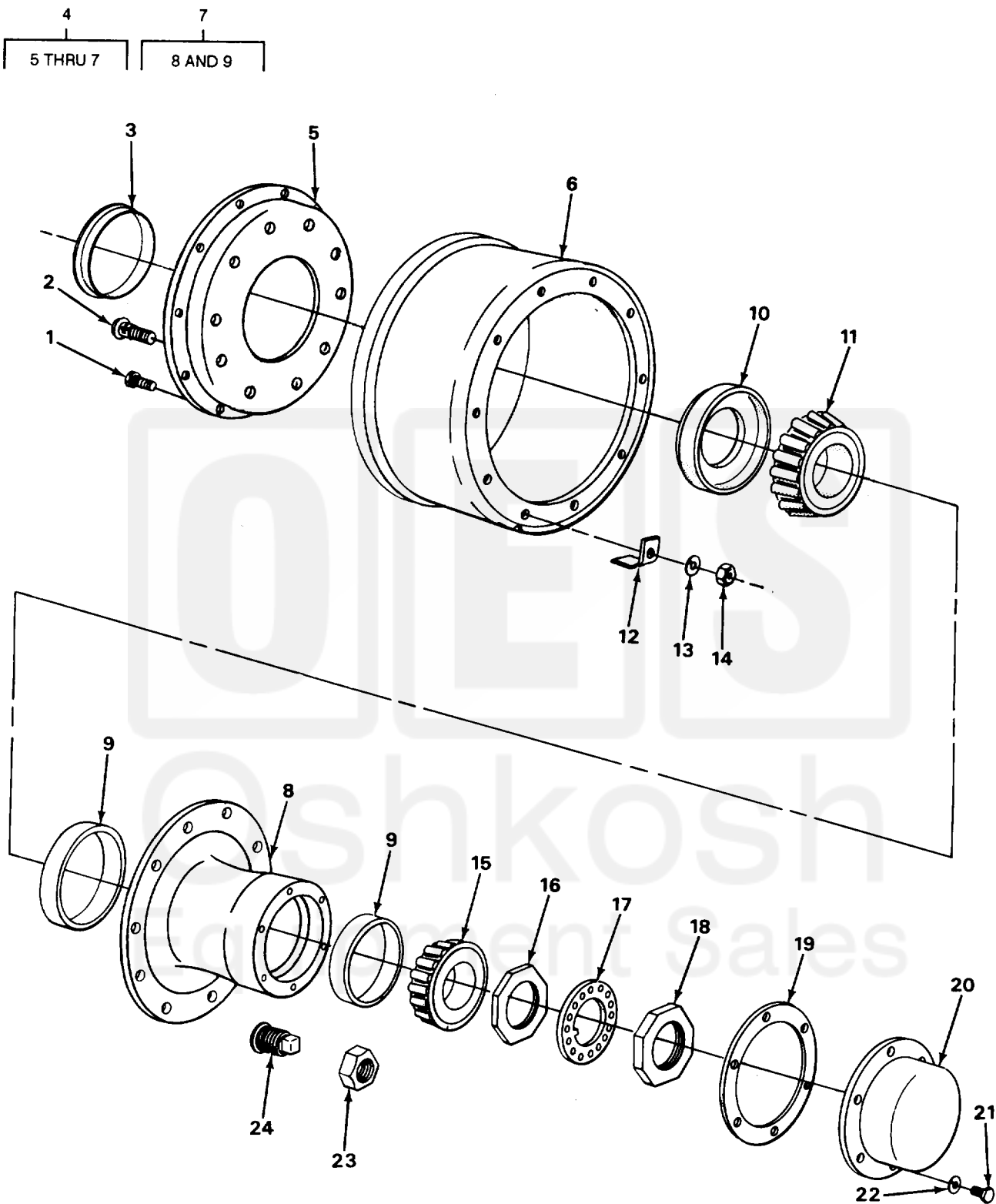

TA706121

FIGURE 39. HUB AND BRAKEDRUM ASSEMBLY (ALL EXCEPT M127).

Current part is item (8,12) on diagram. Available at [www.oshkoshequipment.com](http://www.oshkoshequipment.com)

SECTION (1) ITEM NO	II (2) SMR CODE	(3) CAGEC	TM9-2330-207-24P (4) PART NUMBER	(5) DESCRIPTION AND USABLE ON CODES (UOC)	(6) QTY
GROUP 1311 WHEEL ASSEMBLY					
FIG. 39 HUB AND BRAKEDRUM ASSEMBLY (ALL EXCEPT M127)					
1	PAOZZ	19207	7979179	BOLT,RIBBED SHOULDE UOC:131,133,671,673,674,680,681,682, 684	20
2	PAOZZ	96906	MS51946-1	BOLT,RIBBED SHOULDE LH UOC:131,133,671,673,674,680,681,682, 684	10
2	PAOZZ	96906	MS51946-2	BOLT,RIBBED SHOULDE RH UOC:131,133,671,673,674,680,681,682, 684	10
3	PAOZZ	19207	7409553	RING,WIPER UOC:131,133,671,673,674,680,681,682, 684	2
4	AOOOO	19207	8710721	HUB,WHEEL,VEHICULAR LEFT HAND UOC:131,133,671,673,674,680,681,682, 684	1
4	XBOZZ	19207	8710722	HUB AND DRUM RIGHT HAND UOC:131,133,671,673,674,680,681,682, 684	1
5	PAOZZ	19207	8710724	.ADAPTER,BRAKE DRUM LEFT AND RIGHT UOC:131,133,671,673,674,680,681,682, 684	1
6	PAOZZ	19207	7409394	.BRAKE DRUM VOC:131,133,671,673,674,680,681,682, 684	1
7	XB0ZZ	09389	71936E	HUB ASSEMBLY UOC:131,133,671,673,674,680,681,682, 684	4
8	XB0ZZ	19207	8710723	.HUB,TRAILER WHEEL UOC:131,133,671,673,674,680,681,682, 684	1
9	PAOZZ	21450	706691	.CUP,TAPERED ROLLER UOC:131,133,671,673,674,680,681,682, 684	1
10	PAOZZ	19207	7979349	SEAL,PLAIN ENCASED UOC:131,133,671,673,674,680,681,682, 684	2
11	PAOZZ	96906	MS19081-137	BEARING,ROLLER,TAPE INNER UOC:131,133,671,673,674,680,684	2
12	PAOZZ	19207	7979315	COVER,ACCESS UOC:131,133,671,673,674,680,681,682, 684	1
13	PAOZZ	96906	MS35338-47	WASHER,LOCK UOC:131,133,671,673,674,680,681,682, 684	20
14	PAOZZ	96906	MS51968-11	NUT,PLAIN,HEXAGON UOC:131,133,671,673,674,680,681,682, 684	20

Current part is item (8,12) on diagram. Available at [www.oshkoshequipment.com](http://www.oshkoshequipment.com)

Current part is item (8,12) on diagram. Available at [www.oshkoshequipment.com](http://www.oshkoshequipment.com)

SECTION (1)	II (2)	TM9-2330-207-24P (3)	(4)	(5)	(6)
ITEM NO	SMR CODE	CAGEC	PART NUMBER	DESCRIPTION AND USABLE ON CODES (UOC)	QTY
15	PAOZZ	21450	703077	BEARING,ROLLER,TAPE OUTER UOC:131,133,671,673,674,680,681,682, 684	2
16	PAOZZ	19207	7979308	NUT,PLAIN,OCTAGON UOC:131,133,671,673,674,680,681,682, 684	2
17	PAOZZ	19207	5139123	WASHER,KEY UOC:131,133,671,673,674,680,681,682, 684	2
18	PAOZZ	19207	7979263	NUT,PLAIN,OCTAGON UOC:133,671,673,674,680,681,682	2
19	PAOZZ	19207	8710726	GASKET UOC:131,133,671,673,674,680,681,682, 684	2
20	PAOZZ	19207	8710725	COVER,ACCESS UOC:131,133,671,673,674,680,681,682, 684	2
21	PAOZZ	96906	MS90728-30	BOLT,MACHINE UOC:131,133,671,673,674,680,681,682, 684	12
22	PAOZZ	96906	MS35338-45	WASHER,LOCK UOC:131,133,671,673,674,680,681,682, 684	12
23	PAOZZ	96906	MS51983-3	NUT,PLAIN,SINGLE BA LH THREADS UOC:131,133,671,673,674,680,681,682, 684	10
23	PAOZZ	96906	MS51983-4	NUT,PLAIN,SINGLE BA RH THREADS UOC:131,133,671,673,674,680,681,682, 684	10
24	PAOZZ	96906	MS53068-1	NUT,CAP,DUAL WHEEL L.H. THD UOC:131,133,671,673,674,680,681,682, 684	10
24	PAOZZ	96906	MS53068-2	NUT,CAP,DUAL WHEEL R.H. THD UOC:131,133,671,673,674,680,681,682, 684	10
END OF FIGURE					

Current part is item (8,12) on diagram. Available at [www.oshkoshequipment.com](http://www.oshkoshequipment.com)